

1/8 to 1/12  
(COMPLETED)

1/15 TO 1/26

S. LOS ANGELES ST.

S. LOS ANGELES ST.

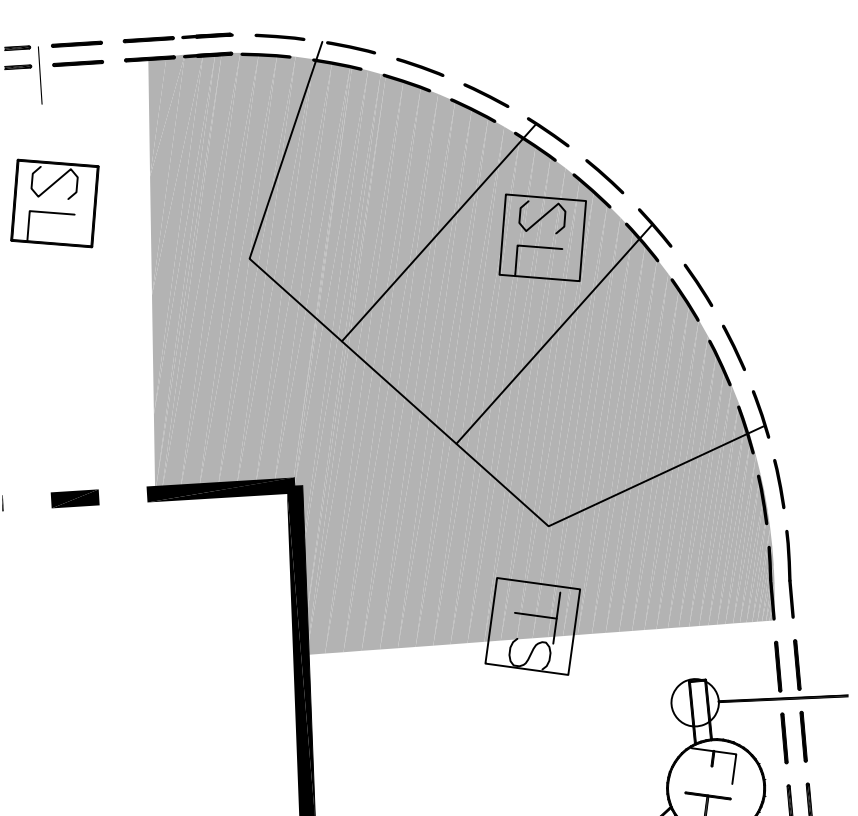
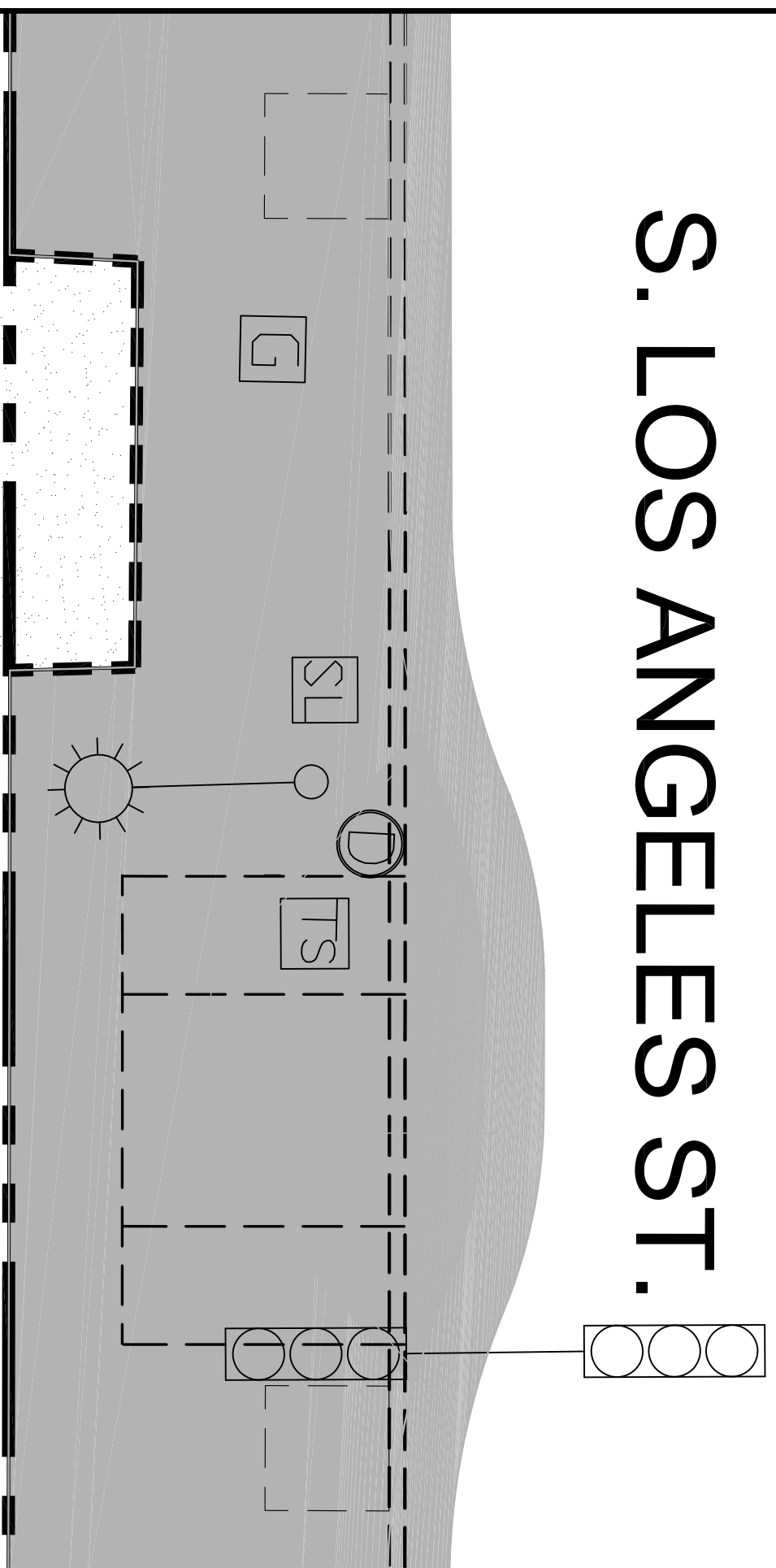

CONSTRUCTION :  
730 S. LOS ANGELES ST.

CONSTRUCTION :  
668 S. LOS ANGELES ST.

SCOPE OF WORK TO BE COMPLETED BY 1/12:  
1) CONSTRUCT NEW SIDEWALK WITHIN BUMP  
OUT

SCOPE OF WORK TO BE COMPLETED BY 1/26:  
1) CONSTRUCT ONE ADA STANDARD RAMP

UTILITIES WORK TO BE COMPLETED BY 1/12:  
1) ADJUST ONE BSL PULL BOX TO GRADE  
2) ADJUST ONE GAS METER BOX TO GRADE

UTILITIES WORK TO BE COMPLETED BY 1/26:  
1) RELOCATE ONE BSL PULL BOX  
2) ADJUST ONE STORM DRAIN MANHOLE TO  
GRADE

# 2-WEEK CONSTRUCTION SCHEDULE

N.T.S.

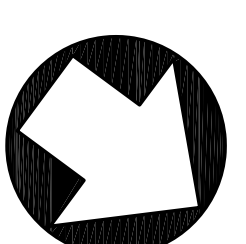

SCALE: NOT TO SCALE

<b>CITY OF LOS ANGELES</b>		<b>DEPARTMENT OF PUBLIC WORKS</b>			<b>BUREAU OF STREET SERVICES</b>																				
VERTICAL CONTROL : [VCONTROL] HORIZONTAL CONTROL : [HCONTROL]	PRINCIPAL CIVIL ENGINEER  DATE: _____  HUGH S. LEE, S.E., C.C.S.	<b>NAZARIO SAUCEDA</b> DIRECTOR ENGINEERING DIVISION INITIAL DATE DESIGNED BY: LAWRENCE LIN CHECKED BY: NISHITH DHANDHA APPROVED BY: ROBERT GUTIERREZ APPROVED BY PROJECT MGR: LAWRENCE LIN	<table border="1" style="width:100%; border-collapse: collapse;"> <thead> <tr> <th>NO.</th> <th>REVISION DESCRIPTION</th> <th>DATE</th> <th>BY</th> </tr> </thead> <tbody> <tr><td> </td><td> </td><td> </td><td> </td></tr> <tr><td> </td><td> </td><td> </td><td> </td></tr> <tr><td> </td><td> </td><td> </td><td> </td></tr> <tr><td> </td><td> </td><td> </td><td> </td></tr> </tbody> </table> WORK ACCEPTED SERIAL NO.  INDEX NO.	NO.	REVISION DESCRIPTION	DATE	BY																	<table border="1" style="width:100%; border-collapse: collapse;"> <tr> <td style="text-align: center; vertical-align: middle;"> </td> </tr> </table>	
NO.	REVISION DESCRIPTION	DATE	BY																						
SHEET TITLE : 2-WEEK LOOK AHEAD - 1/15 TO 1/26  PROJECT : FASHION DISTRICT PHASE II STREETSCAPE PROJECT  ADDRESS: S.LOS ANGELES ST BETWEEN OLYMPIC BLVD AND 7TH ST.	WORK ORDER NO. <b>M0014217</b>  DRAWING NO.	SHEET <b>2-WK</b> OF SHEETS			CITY OF LOS ANGELES DEPARTMENT OF PUBLIC WORKS BUREAU OF STREET SERVICES																				